



DATASHEET

## PAN SPEAKER P 8-15 -PI - PASSIVE COLUMN SPEAKER



The **Pan Speaker P 8-15-Pi** is a passive speaker, mounted in an attractive compact design which is able to reproduce a clear sound in a distance of up to 25m. The loudspeaker consists of 16 x 2,1" drivers in closed aluminum housing. The housing can be delivered in all RAL colors on customer's request. The chassis are protected against external influences by a perforated metal sheet. There is a two-pin plug connection at the back of the P08-15 that's also available in R version, for rental applications. At the back and sides of the **P 8-15** there are nuts with adjustable slot nuts which enable wall mounts and brackets. The **P 8-15** can be used individually or in combination with the P S-208 Subwoofer.

### FEATURES

High efficiency, integrated protection circuits, high speech intelligibility even in the most adverse acoustic environments, sleek and unobtrusive design

For the **Pan Speaker series** there is a wide range of mounting accessories for fixed installations and mobile applications.

All **Pan Speakers** are developed, designed and manufactured by Pan Acoustics which uses high quality materials according to the stringent criteria.

### MADE IN GERMANY

### ADDITIONAL OPTIONS

- 100 V
- IP 65 (special modification)
- RAL Colour Option  
(Standard color: Aluminum RAL 9006)

### APPLICATIONS

Churches, Mosque, Museum, Live Sound,  
Train stations, Airports, Sports grounds, Parliament  
Conference rooms, Auditorium, Shopping center,  
A/V Installations

Dok.-Nr.: 2014\_V00072

**MADE IN GERMANY** - All products are developed and manufactured by Pan Acoustics in Germany.

Pan Acoustics reserves the right to change product specification without notice.

[www.pan-acoustics.de](http://www.pan-acoustics.de)

Pan Acoustics GmbH | Lindener Str. 15 | D-38300 Wolfenbüttel | Germany | Tel.: +49 (0) 5331 900 95 70 | E-Mail: kontakt@pan-acoustics.de

## TECHNICAL DATA PAN SPEAKER P 8-15-PI

### ACOUSTIC SPECIFICATION

<b>Type</b>	passive column speaker
<b>Frequency response:</b>	135 Hz - 18 kHz (+3/-10dB)*
<b>Drivers:</b>	16 x 2,1"
<b>Rated Power:</b>	300 W (peak <sub>20ms</sub> ) / 200 W (program) / 100 W (nominal)
<b>Recommended amplifier:</b>	Lab. Gruppen Lycia-Serie or IPD 1200
<b>Sensitivity:</b>	89 dB 1W/1m
<b>Maximum SPL:</b>	126 dB* @1m
<b>Nominal Impedance:</b>	8 Ohm
<b>Dispersion</b>	
<b>horizontal:</b>	140°
<b>vertical:</b>	20°
<b>Connectors:</b>	2 x twp-pin plug contact
<b>Temperature range:</b>	-10°C - +50°C Enviroment

\*anechoic halfspace conditons

### GENERAL SPECIFICATION

<b>Enclosure:</b>	Aluminium-Profile
<b>Grille:</b>	Powder coated perforated steel
<b>Colour:</b>	Aluminium RAL 9006
<b>Dimensions (HxWxD):</b>	906 x 112 x 103 mm
<b>Weight:</b>	4,9 kg

## TECHNICAL DRAWING PAN SPEAKER 01-PI, 02-PI, 04-PI/R, 08-PI/R, 8-15-PI/R

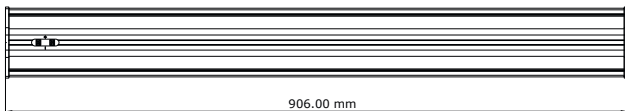

P08-Pi

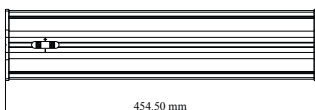

P04-Pi

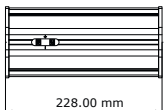

P02-Pi

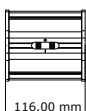

P01-Pi

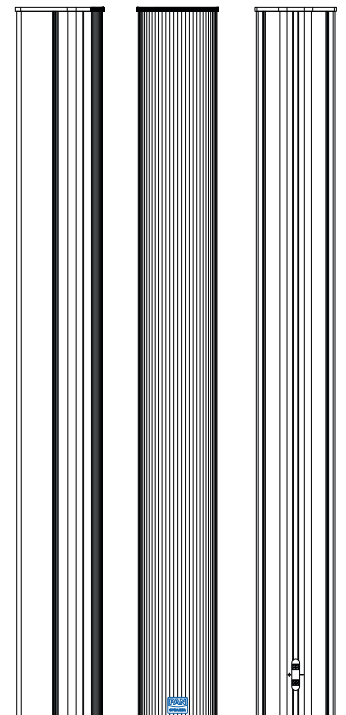
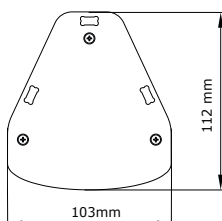

**MADE IN GERMANY** - All products are developed and manufactured by Pan Acoustics in Germany.

Pan Acoustics reserves the right to change product specification without notice.

[www.pan-acoustics.de](http://www.pan-acoustics.de)

Pan Acoustics GmbH | Lindener Str. 15 | D-38300 Wolfenbüttel | Germany | Tel.: +49 (0) 5331 900 95 70 | E-Mail: kontakt@pan-acoustics.de